

Grinding Wheel Belt Driven Spindle Specification

Type	Color	Lubricant	Adapter	A(Ø)	B(mm)	C(mm)	D(mm)	rpm	Diameter (Ø)
FA-90-800-01-F	None	Grease	DV-26	90	265	318.5	-	8000	65 / 150
FA-90-800-01	Green	Grease	DV-22	90	245	297	-	8000	65 / 150
FA-90-1500-01	Red	Grease	DV-16	90	245	297	-	15000	35 / 70
FA-90-2000-01	Gold	Grease/Oil gas	DV-14	90	245	294	60	20000	24 / 40
FA-90-3000-01	Blue	Grease/Oil gas	DV-10	90	242.5	292.6	60	30000	15 / 25
FA-90-4000-01	Purple	Grease/Oil gas	DV-8	90	242.5	292.6	60	40000	12 / 16
FA-90-5000-01	Orange	Grease/Oil gas	DV-7	90	238.5	276.5	60	50000	9 / 13
FA-90-6000-01	Bright black		DV-5	90	237.7	275.8	-	60000	6 / 8
FA-90-8000-01	Bright black	Oil gas	DV-5	90	237.7	275.8	-	80000	6 / 8
FB-70-2000	Red	Grease	DV-14	70	244.7	293.7	-	20000	24 / 40
FB-70-3000	Gold	Grease	DV-10.5	70	242.5	287.5	-	30000	15 / 25
FB-70-1000	Blue	Grease	DV-16	70	245	298	-	10000	45 / 80

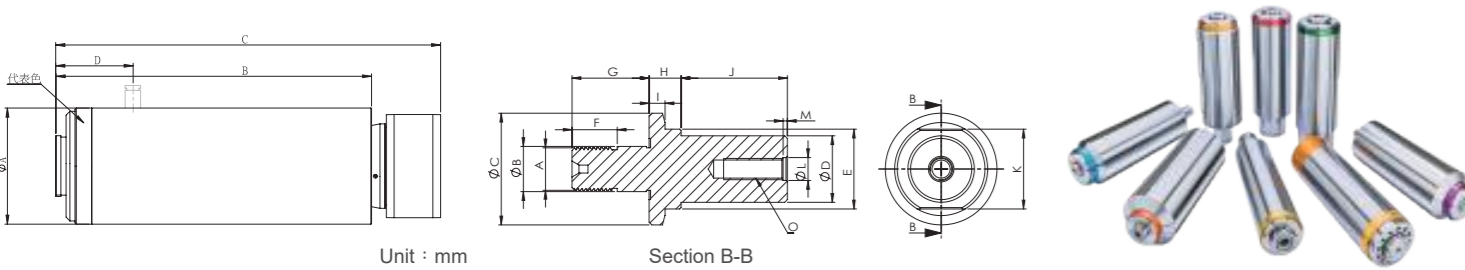

Adapter Specification

Adapter	A	B ^{-0.005 -0.015}	C	D x J	E	F	G	H	I	K	L	M	O
DV-26	M26 x 2P	28	54	Ø40 x 100 Ø60 x 70 Ø50 x 40	-	25	41	15	9	48	11	1.5	M10
DV-20	M20 x 1.5P	22	20	Ø40 x 85 Ø40 x 60 Ø50 x 40	50	22	40	14	22	45	11	1.5	M10
DV-16	M16 x 1.5P	17	42	Ø32 x 100 Ø25 x 60 Ø25 x 35	35	17	29	12	17	30	9	1.5	M8 x 1.25P
DV-14	M14 x 1.5P	15	38	Ø24 x 80 Ø20 x 60 Ø16 x 40	30	17	28	10	15	24	7	1.5	M6 x 1.0P
DV-10	M10 x 1.5P	10.5	30	Ø16 x 40 (M6) Ø13 x 30 (M6) Ø10 x 25 (M4)	24	15	24	10	10.5	20	7	1.5	M6 x 1.0P M4 x 0.7P
DV-08	M8 x 1.25P	8.5	24	Ø12 x 35 (M6) Ø10 x 30 (M4) Ø8 x 24 (M4)	18	12	24	10	8.5	18	7	1.5	M6 x 1.0P M4 x 0.7P
DV-07	M7 x 1P	7.5	21	Ø8 x 30 (M4) Ø7 x 25 (M3) Ø6 x 20 (M3)	15	12	21	10	7.5	16	4.5	1.2	M4 x 0.7P
DV-05	M5 x 0.8P	5.5	20	Ø7 x 25 (M3) Ø6 x 20 (M3) Ø5 x 15 (M3)	-	10	18.5	9	5.5	15	3.5	1.2	M3 x 0.5P

Built-in Spindle Specification

Type	Color	Adapter	Lubricant	rpm	øA (mm)	øB (mm)	C (mm)	øD (mm)	E (mm)	L (mm)	Voltage (V)	S1 Current (A)	S1 Power (kW)	S1 Torque (Nm)
CF1208-15	Green	DV-26	Grease	15000	100	60	55	120	11.5	369	220	21	5.5	6.6
CF1215-30	Blue	DV-22	Grease	30000	97	59	55	120	11.5	337	220	28	7.5	4.9
CF1206-90	Black	DV-08	Oil gas	90000	65	24	44	120	7	224	220	17	4.2	0.5
CF1209-12	Purple	DV-07	Oil gas	120000	60	20	40	120	7	210	200	10	2.5	0.2

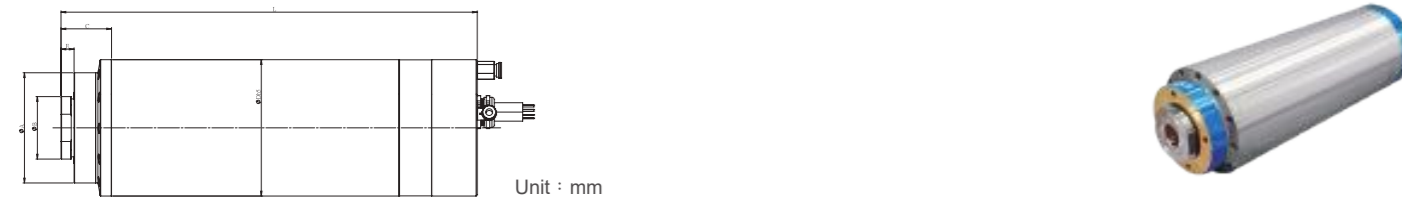

Spindle
Sand Wheel



COMORK PRECISE MACHINERY CO., LTD.
No. 49, Ln. 92, Sec. 3, Yongping Rd., Taiping Dist., Taichung City 411, Taiwan
Tel: +886-4-2251-1128
Fax: +886-4-2351-1148
E-mail: ccm.trm@msa.hinet.net



CHUAN-YEN CO., LTD.
No. 12, Ln. 547, Sec. 2, Yongping Rd., Taiping Dist., Taichung City 411, Taiwan
Tel: +886-4-2275-0499
Fax: +886-4-2273-7662
E-mail: ccm.trm@msa.hinet.net

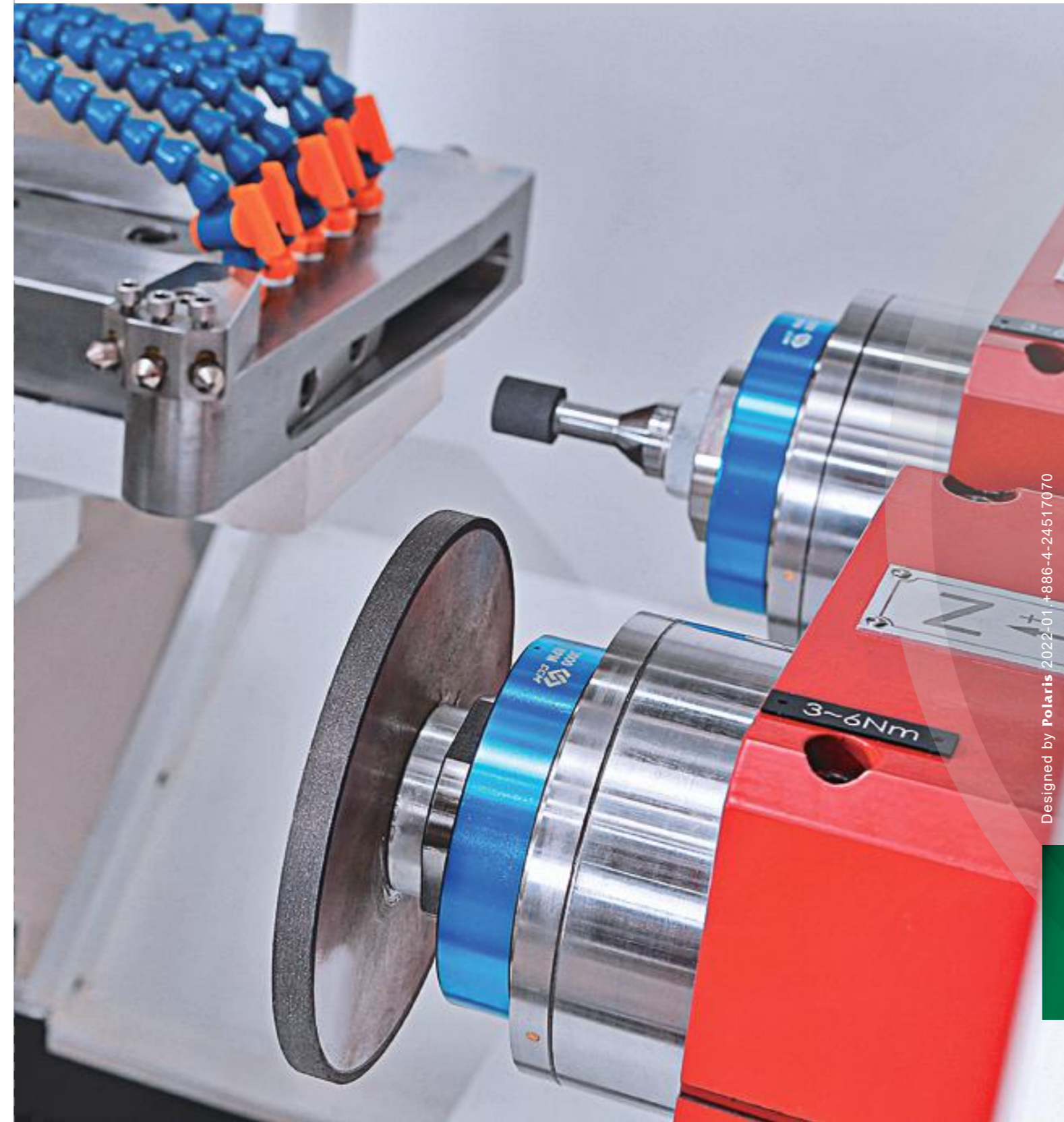

COMORK
COMORK PRECISE MACHINERY

Grinding Our Dream

Innovation on the fundamental of grinding.
Create the new chapter of grinding craft.



GJ-400
CNC Hybrid ID&OD
Grinding Machine

www.ccm-comork.com



General Manager
周金吉



- 1997-2003**
Founded in 1997, CCM has devoted to the research and development of grinding processing. As CCM develops state-of-the-art grinding technology, its number of orders drastically increased. CCM then built new factories to expand its production. By integrating internal resources, CCM is able to provide comprehensive services.
- 2003-2010**
By independent R&D of new products, from raw materials to final product, CCM satisfies the market's needs through its one-stop grinding production services. The procurement of Zeiss three-dimensional measuring machines raises product competitiveness.
- 2011**
Relying on Chuan-Yen's technological foundation, Ko-Yen Precise Machinery Co., Ltd. was officially founded on August 5th in response to the needs of the market. In September of the same year, Ko-Yen released the internal grinding spindle series for its private brand CCM, opening a new vista for CNC grinding machines with high-precision, high-performance innovative craftsmanship.
- 2012-2017**
Acquired significant technological breakthroughs, Ko-Yen successfully developed GJ-400 & GO-350 CNC internal cylindrical compound grinding machines, and GO-354 & GO-356 CNC Cylindrical Grinding Machine. The debut with exhibited product sold on-site at the Taipei Intelligent Machinery & Manufacturing Technology Show and the TIMTOS, significantly enhanced the brand's exposure.
- 2018-2021**
In 2018, Ko-Yen bought a pre-construction land for company expansion. At the end of 2020, Ko-Yen's new plant comes into operation with more comfortable work environment. The new brand COMORK provides top-quality services to its clients with refreshing appearance.



Company
Profile

A Fisherman's Son Raises the Sails In Pursuit of Grinding Excellence

President Quan-ji Zhou was born into a family from Qingkunshen, Taiwan, that relied on the sea for their livelihood. The ever-shifting nature of the ocean shaped General Manager Zhou into a resilient man with sharp intuitions and a desire to excel.

It is through the accumulation of experience that Zhou refined the grinding technology needed to raise his sail of dreams. He has devoted much of what he has learned into machine manufacturing, thereby providing excellent services for upstream clients, as well as meeting the needs of the global grinding industry.

Taking a page out of his own life experiences, President Zhou emphasizes on "the foundation of technology and the sources of achievement" in discovering and cultivating value for the team client users. By giving back to the society, COMORK works alongside its companions in setting the sail for grinding excellence and overcoming challenges in the ever-changing market, thereby creating a future value which benefits all parties.



GJ-400 CNC Hybrid ID & OD Grinding Machine

CNC Internal Cylindrical Compound Grinding Machine

COMORK GJ-400 series CNC hybrid ID&OD grinding machine,both can do ID grinding and OD grinding.And only need clamp one time,then can finish multifaceted processing.Beside make considerable reduction for equipment cost and labor cost,both can increase efficiency and varied processing.

Machine feature

- Are available to choose various rotation speed spindles, to reach the highest grinding efficiency.
- ID, OD, end face and bevel grinding once for all.
- Dual grinding spindle which is capable to grind inner/outer diameter and end face in one process.
- High rigidity structure, to make sure the best grinding stability.
- This machine equip FANUC Oi-TF controller.
- X, Y, Z axis both mount high degree of precision linear guide.
- Only need clamp one time, can finish multifaceted processing.
- Non-circular grinding function.(option installation)
- Totally-enclosed casing.

Multifaceted processing, Once and For All

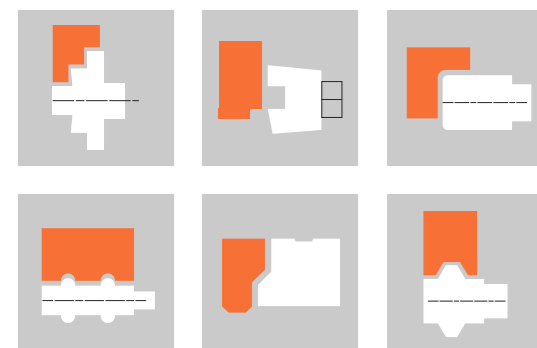

66mm Through Hole Workhead Spindle (Option)
Can put the longer and heavier workpiece, and higher rigidity.



Workhead C-axis (Option)
With special software, and C-axis can do the non-circular grinding and thread grinding.



Fine Adjustment
The fine adjustment allows for taper corrections in the 1µm range.(Total range ± 20 µm)

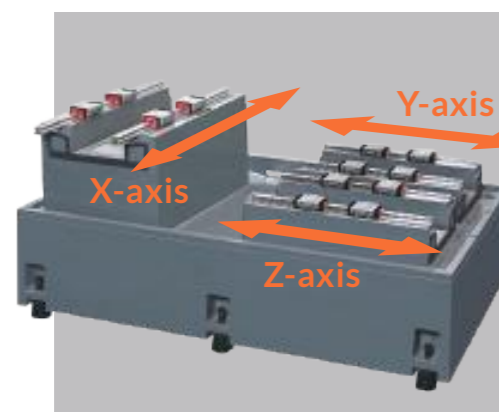

X, Y, Z axis Linear Guide
X, Y, Z axis both mount high degree of precision linear guide.

Machine Base
High rigidity structure, to make sure the best grinding stability.

Multi direction wheel dressing device
Patent structure design, with composite material to reach the best rigidity and aseismatic.



Dual Grinding Spindle

Dual grinding spindle which is capable to grind inner/outer diameter and end face in one process. ID,OD,end face and bevel grinding once for all.
Grinding spindle type :
• Belt driven : 8,000~50,000 rpm
• Built-in motor :8,000~120,000 rpm



Automatic Sensing Function

Monitoring the current of spindle motor, when wheel touch the workpiece, the current strength of spindle motor will rise.By this phenomenon to eliminate empty stroke. And also can reduce human negligence and increase efficiency.



Pictogramming

Original pictogramming based on FANUC system ,all controls are clearly and engormically arranged,an important role is played by the manual control unit ,which facilitate setup close to the grinding process.And built-in security settings and error warning,prevent new wrokers keyin error,so new wrokers also can finish setup procedure and manufacture.And built-in security settings and error warning,prevent new wrokers keyin error,so new wrokers also can finish setup procedure and manufacture.



Customization Operate Panel

For user's idiomatic gestures to design the best operate panel.

Customization Operate Panel

For user's idiomatic gestures to design the best operate panel.

Grinding Our Dream

Innovation on the fundamental of grinding.
Create the new chapter of grinding craft.

Machine Specification

Type	GJ-400A	GJ-400B
Max. Workpiece Diameter	Ø400 mm	
Workhead Revolve Speed	0~1,000 rpm	
Spindle Plane Manual Angle Adjust	+15° & -2°	
Max. Travel : X axis	360 mm	
Max. Travel : Y/Z axis	340 + 240 mm	
ID Processing Range	Ø0~310 mm	
Max. ID Length Processing Range	380 x 100 mm	
OD Processing Range	250 mm	
Max. Weight of Workpiece	56 kgs	
X/Y/Z axis Travel Speed	0~10,000 mm/min	
Axis Travel Unit	0.0001 mm	
Workhead Spindle Motor	AIF8 / 3,000 1.6 kw Wheel head A-5	
Wheel Spindle Motor	3HP 2kw 2P	
Wheel Spindle Speed	Wheel spindles 8000~50000 rpm (choose two)(Grease)	
Power Requirement	15 kw	
Net weight of Machine	4,500 kgs	

Machine Dimension

